

**Let the  
competition  
begin!!**

**2017**

What is the colour of Mr. Edward's puppy?

- a. White
- b. Black
- c. Chocolate
- d. None of the above

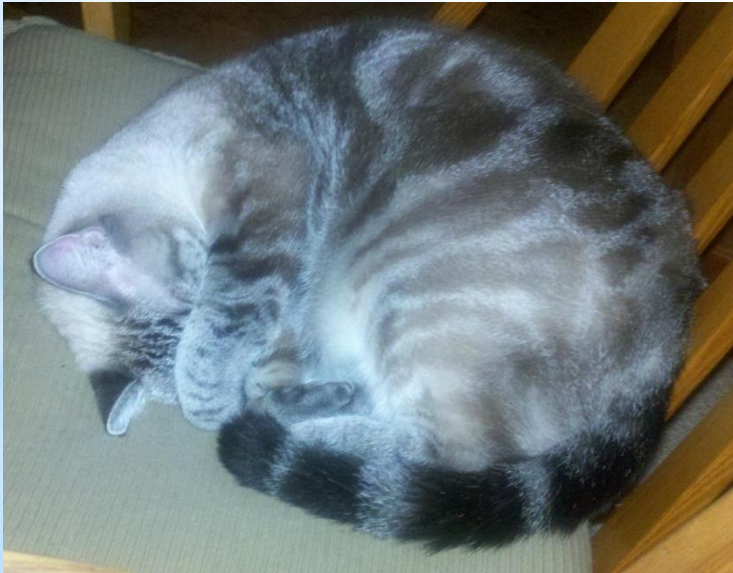

**Question 1**

What is the colour of Mr. Edward's puppy?

A. **WHITE**

b. Black

c. Chocolate

d. None of the above



**Answer 1**

Information of the Kuwait (kw) University (edu) Health Science Center (hsc) Health, Safety and Environment (hse) program with the Vice Presidents Office (vpo) can be found at the following link:

- a. <http://www.hsc.kw/vpo/HSE>
- b. <http://www.hsc.edu.kw/vpo/HSE>
- c. <http://www.hsc.com/vpo/HSE>
- d. <http://www.hsc.com/HSE>

## Question 2

Information of the Kuwait (kw) University (edu) Health Science Center (hsc) Health, Safety and Environment (hse) program with the Vice Presidents Office (vpo) can be found at the following link:

a. <http://www.hsc.kw/vpo/HSE>

**b. <http://www.hsc.edu.kw/vpo/HSE>**

c. <http://www.hsc.com/vpo/HSE>

d. <http://www.hsc.com/HSE>

**Answer 2**

Pipette tips are best placed in:

- a. Yellow sharps containers;
- b. Black sharps containers;
- c. a and b
- d. None of the above

## Question 3

Pipette tips which can cause puncture wounds are best placed in:

**A. YELLOW SHARPS CONTAINERS;**

b. Black sharps containers;

c. a and b

d. None of the above

**Answer 3**

# Question 4

Sharps containers :

- a. Should come with a fill line
- b. Should be Appropriately labeled with the Biohazard symbol
- c. Maybe manufactured in the colours yellow or red
- d. Should have lids securely in place before use
- e. All of the above (a,b,c,and d)
- f. Only a, b, and d



# Answer 4

Sharps containers :

- a. May not filled more than  $\frac{3}{4}$  full
- b. Should be Appropriately labeled with the Biohazard symbol
- c. Maybe manufactured in the colours yellow or red
- d. Should have lids securely in place before use
- e. All of the above (a,b,c, and d)**
- f. Only a, b, and d

In the paper on the review of the literature of fomites used by healthcare personnel and potential sources of bacteria, the following items were assessed :

- a. Mobile phones
- b. Sinks
- c. Ties
- d. Lab coats
- e. a, c, and d
- f. c and d

## Question 5

In the paper on review of the literature of fomites used by healthcare and potential sources of bacteria, the following items were assessed :

a. Mobile phones

b. Sinks

c. Ties

d. Lab coats

**E. A, C, AND D**

f. c and d

**Answer 5**

# Question 6

Hand hygiene steps with sanitizer should take

- a. 10 seconds
- b. 20- to 30 seconds
- c. As fast as you can
- d. 5 minutes
- e. None of the above

# Answer 6

Hand hygiene steps with sanitizer should take

- a. 10 seconds
- b. 20- TO 30 SECONDS**
- c. As fast as you can
- d. 5 minutes
- e. None of the above

# Question 7

When wearing PPE (gloves):

- a. Select the correct size
- b. Change gloves frequently
- c. Wash gloves frequently
- d. Recycle gloves
- e. a and b
- f. c and d

# Answer 7

- a. Select the correct size
- b. Change gloves frequently
- c. Wash gloves frequently
- d. Recycle gloves
- E. A AND B**
- f. c and d

# Question 8

When cleaning biohazard spills, do the following:

- a. Ignore it
- b. Contact the HSC Medical Waste Management Committee and ask them to cleanup the spill
- c. Use a spray, wipe, spray method with a disinfectant
- d. Utilize the spill kit in you location after you have assessed the hazard
- e. c and d



# Answer 8

When cleaning biohazard spills, do the following:

- a. Ignore it
- b. Contact the HSC Medical Waste Management Committee and ask them to cleanup the spill
- c. USE A SPRAY, WIPE, SPRAY METHOD WITH A DISINFECTANT**
- d. Utilize the spill kit in you location after you have assessed the hazard
- e. c and d

# Question 9

Expiration dates of all products used in each of your labs or facilities should be checked regularly

- a. True
- b. False

# Answer 9

Expiration dates of all products used in each of your labs or facilities should be checked regularly

**A. TRUE**

b. False

# Question 10

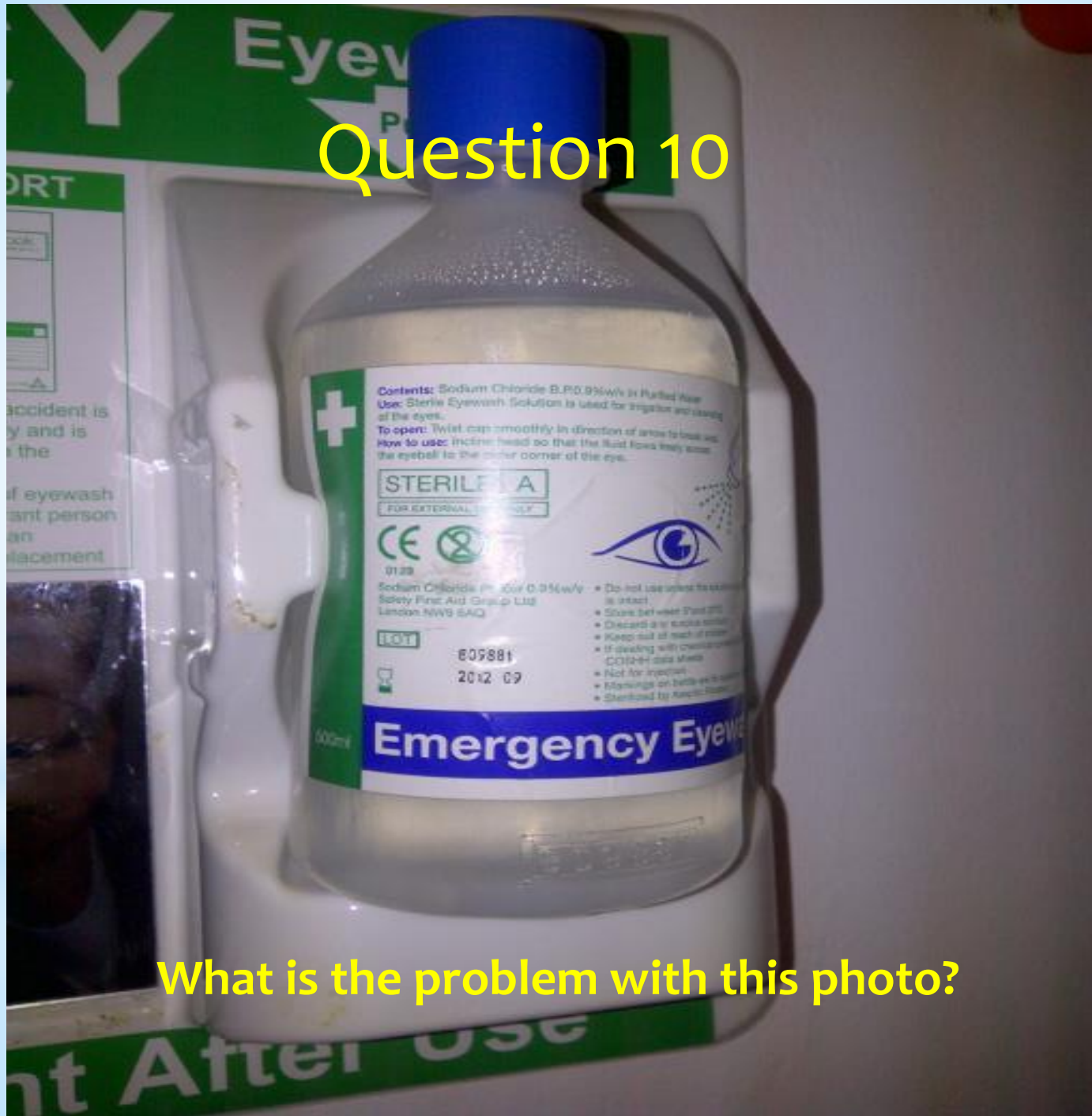

What is the problem with this photo?

**Expiration date : Expired  
product**

**2012 09**



**Answer 10**

\*What is the name of Mr. Edward's traveling Teddy Bear?

- a. Bin Bear
- b. BBP
- c. KFB
- d. Winne the Pooh

## Question 11

\*What is the name of Mr. Edward's traveling Teddy Bear?

- a. **BIN BEAR**
- b. BBP
- c. KFB
- d. Winne the Pooh



**Answer 11**

Dr. Ignaz Philipp Semmelweis was a Hungarian physician who championed:

- a. Pharmaceuticals
- b. Hand hygiene
- c. Chemical safety
- d. Clean water

 **Question 12**



Dr. Ignaz Philipp Semmelweis was a Hungarian physician who championed:

- a. Pharmaceuticals
- b. Hand hygiene**
- c. Chemical safety
- d. Clean water

**Answer 12**

Dr. Joseph Lister was credited with using Carbolic acid (phenol) as an antiseptic, becoming known as the father of modern surgery...

- a. True
- b. False

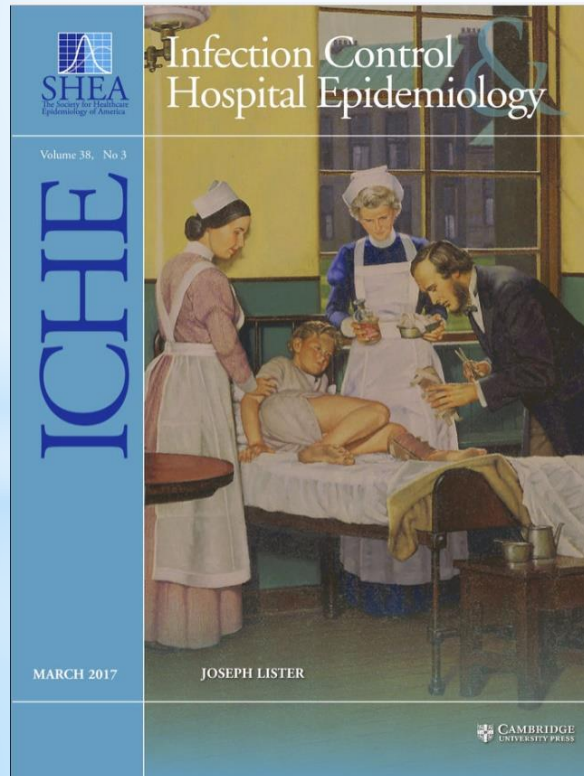

## Question 13

Dr. Joseph Lister was credited with using Carbolic acid (phenol) as an antiseptic, becoming known as the father of modern surgery...

- a. True
- b. False

*He first suspected it would prove an adequate disinfectant because it was used to ease the stench from fields irrigated with sewage waste. He presumed it was safe because fields treated with carbolic acid produced no apparent ill-effects on the livestock that later grazed upon them.*

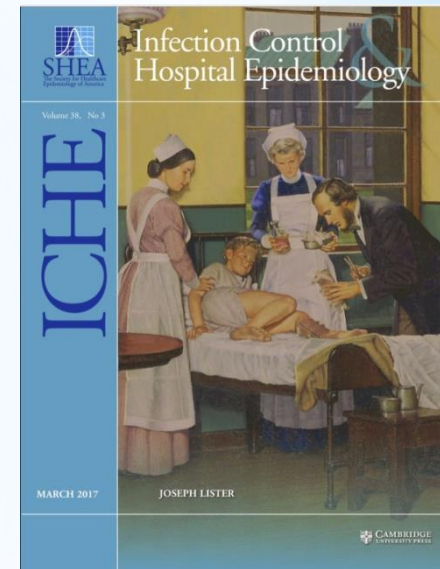

Answer 13

True or False:

Ethanol, Isopropanol ( 70 % - most appropriate concentration for disinfection)

Is flammable

Has a low BP, higher evaporation rate, difficult to get 10 minute contact time

**Question 14**

**True** or False:

Ethanol, Isopropanol ( 70 % - most appropriate concentration for disinfection)

Is flammable

Has a low BP, higher evaporation rate, difficult to get 10 minute contact time

70 to 85% is actually considered the appropriate concentration range

**Answer 14**

The Chain of Infection has how many components

- a. 3
- b. 6
- c. 9
- d. 12

Question 15

The Chain of Infection has how many components

- a. 3
- b. 6
- c. 9
- d. 12

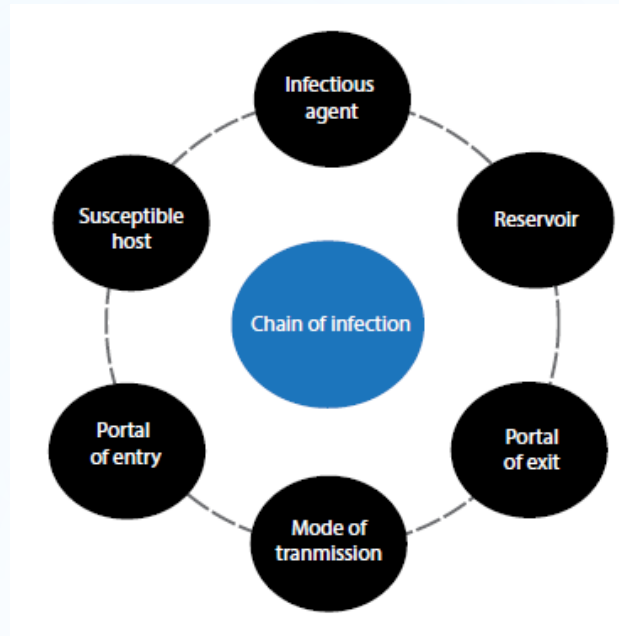

Answer 15

For disinfectants to work properly, one needs to follow the manufacturers instructions for contact time

- a. True
- b. False

## Question 16



For disinfectants to work properly, one needs to follow the manufacturers instructions for contact time

- a.** True
- b.** False

# Question 16

**Risk:** The **likelihood**, or possibility, that harm (injury, illness, death, **damage** etc.) may **occur**

- a. True
- b. False

## Question 17

Risk: The likelihood, or possibility, that harm (injury, illness, death, damage etc.) may occur

- a. TRUE
- b. False

**Answer 17**

The following are not considered PPE

- a. Gloves
- b. Lab coats
- c. Shoes
- d. Open toed shoes/Sandals
- e. Safety glasses

# Question 18

The following are not considered PPE

- a. Gloves
- b. Lab coats
- c. Shoes
- d. OPEN TOED SHOES/SANDALS**
- e. Safety glasses

**Answer 18**

The most common mode of occupational exposure by health care workers to infectious agents around world is still:

- a. Inhalation
- b. Percutaneous injury
- c. Splash with blood/body/fluid/chemical
- d. Ingestion

# Question 19

The most common mode of occupational exposure by health care workers to infectious agents around world is still:

- a. Inhalation
- b. PERCUTANEOUS INJURY**
- c. Splash with blood/body/fluid/chemical
- d. Ingestion

**Answer 19**

## Question 20

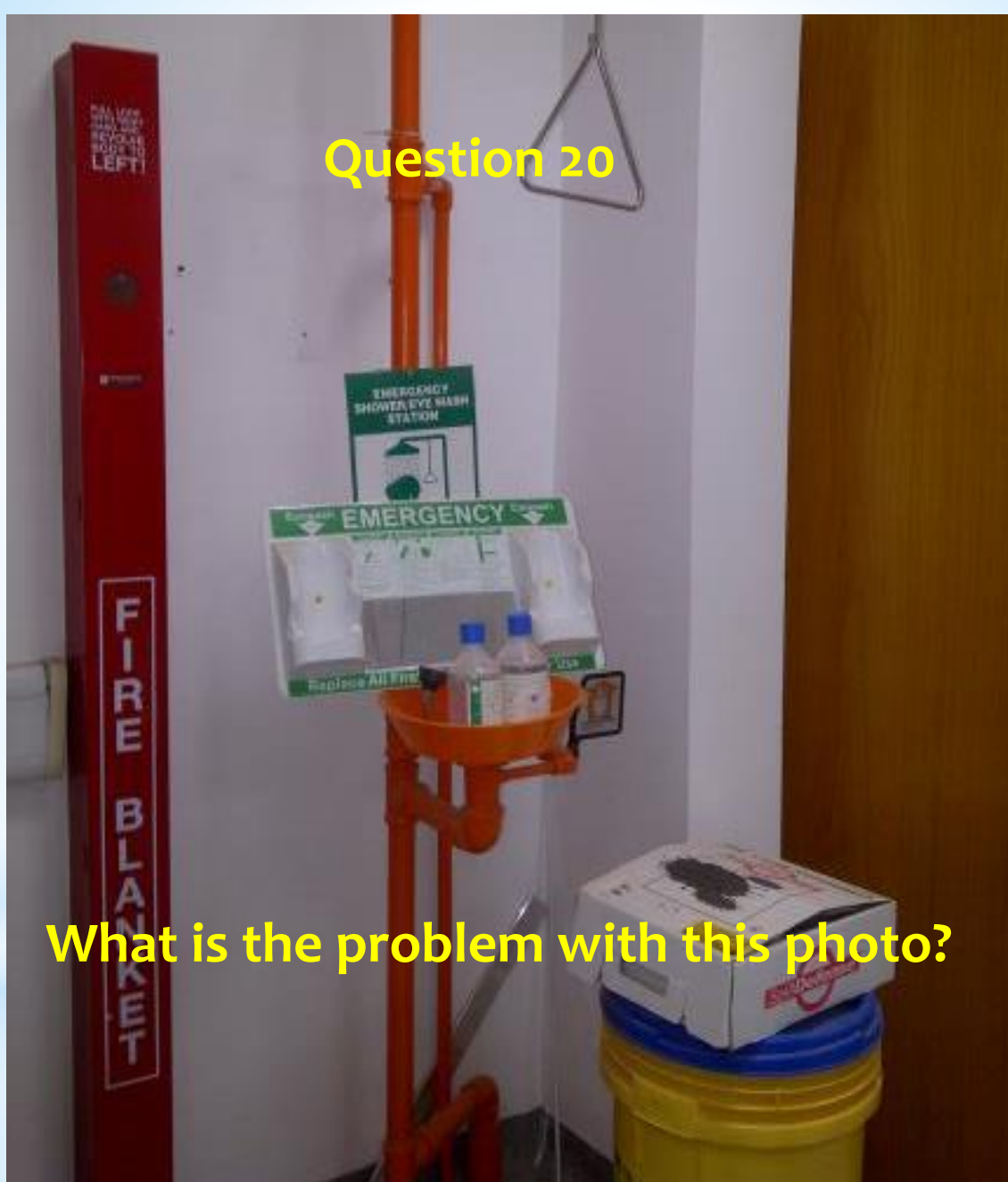

What is the problem with this photo?



1. Eyewash station / shower can't be used – blocked by containers
2. Shower can't be used – blocked by containers
3. Eyewash station can't be used as basin filled with signage and plastic bottles
4. Waste ( dust/debris?) On box
5. Spill kits not appropriately stored



# Answers 20

## Bonus Question 1 if we have a Tie

Put the following in appropriate order from the Chain of Infection

Portal of Entry

Mode of Transmission

Reservoir

Susceptible Host

Portal of Exit

Infectious Agent

## Bonus Question 1 Answers

Put the following in appropriate order from the Chain of Infection

Portal of Entry

Mode of Transmission

Reservoir

Susceptible Host

Portal of Exit

Infectious Agent

Infectious Agent

Reservoir

Portal of Exit

Mode of Transmission

Portal of Entry

Susceptible Host

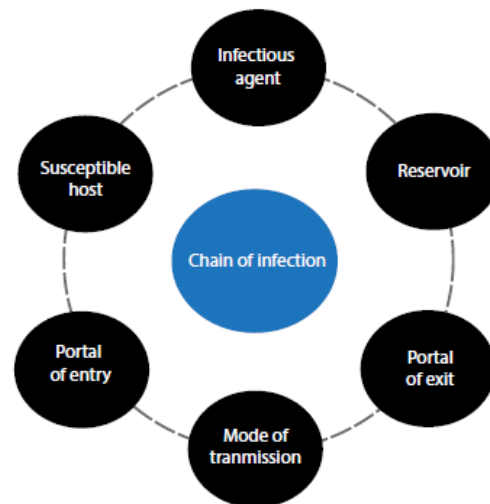

## Bonus Question 2

Put the following in appropriate order when performing hand hygiene

- Rub hands
- Apply sanitizer
- Rotational rubbing of each thumb
- Allow to dry
- Rub fingers over the top of each other interlaced (left over right/right over left)
- Palm to Palm with fingers interlaced
- Back of fingers to opposing palms
- Rotational rubbing of clasped fingers in each palm

## BONUS QUESTION 2 ANSWERS!

Put the following in appropriate order when performing hand hygiene

- Rub hands
  - Apply sanitizer
  - Rotational rubbing of each thumb
  - Allow to dry
  - Rub fingers over the top of each other interlaced ( left over right/right over left
  - Palm to Palm with fingers interlaced
  - Back of fingers to opposing palms
  - Rotational rubbing of clasped fingers in each palm
1. **Apply sanitizer**
  2. **Rub hands**
  3. **Rub fingers over the top of each other interlaced ( left over right/right over left**
  4. **Palm to Palm with fingers interlaced**
  5. **Back of fingers to opposing palms**
  6. **Rotational rubbing of each thumb**
  7. **Rotational rubbing of clasped fingers in each palm**
  8. **Allow to dry**

# How to Handrub?

RUB HANDS FOR HAND HYGIENE! WASH HANDS WHEN VISIBLY SOILED

 Duration of the entire procedure: 20-30 seconds

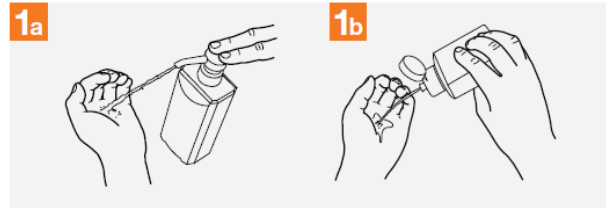

1a Apply a palmful of the product in a cupped hand, covering all surfaces;



2 Rub hands palm to palm;



3 Right palm over left dorsum with interlaced fingers and vice versa;



4 Palm to palm with fingers interlaced;



5 Backs of fingers to opposing palms with fingers interlocked;



6 Rotational rubbing of left thumb clasped in right palm and vice versa;

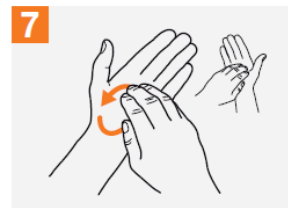

7 Rotational rubbing, backwards and forwards with clasped fingers of right hand in left palm and vice versa;



8 Once dry, your hands are safe.



World Health  
Organization

Patient Safety  
A World Alliance for Safer Health Care

SAVE LIVES  
Clean Your Hands

All reasonable precautions have been taken by the World Health Organization to verify the information contained in this document. However, the published material is being distributed without warranty of any kind, either expressed or implied. The responsibility for the interpretation and use of the material lies with the reader. In no event shall the World Health Organization be liable for damages arising from its use. WHO acknowledges the Hôpital Universitaire de Genève (HUG), in particular the members of the Infection Control Programme, for their active participation in developing this material.